

Elverum 第 1 座

Main table with columns for unit types (A1, A2, A3, A5, B, C, D, E, F), floor numbers (35/F to 19/F), and unit details including area, price, and status. Includes a 'REFUGE FLOOR' section.

TRANSFER PLATE 結構轉換層

COVERED LANSCAPE 有蓋園景區

LEFT LOBBY 升降機大堂

CAR PARKING 停車場



Legend table with colored boxes and text: 即發, 銷安(出售 08/06), 銷安 A1 (指明單位), 銷安 A2 (指明單位), 招標(結束 10/31), 銷安/招標 5, 未出銷安, 未有資料, 停售, 已售

Elverum 第 1 座

35/F		G		H		J		K		L		M		N		P		35/F																	
		開放式(開廚)		開放式(開廚)		2房(開廚)		2房(開廚)		2房(開廚)		2房(開廚)		2房(開廚)		2房(開廚)																			
		實用 235'		實用 234'		實用 482'		實用 422'		實用 424'		實用 450'		實用 441'		實用 418'																			
[4]	4,199,000 @17,868	[4]	4,199,000 @17,944	[5]	8,235,000 @17,085	[4]	7,548,000 @17,886	[2]	6,422,200 @15,147	[2]	6,422,200 @15,147	[2]	6,475,000 @14,683	[5]	7,531,000 @18,017	[B1]	3,695,100 @15,724	[B1]	3,695,100 @15,791	[B1]	7,246,800 @15,035	[B1]	6,642,200 @15,740	[B1]	6,627,200 @15,855	[A1]	3,569,100 @15,188	[A1]	3,569,100 @15,253	[A1]	6,999,700 @14,522	[A1]	6,415,800 @15,203	[A1]	6,401,300 @15,314
[4]	4,188,000 @17,821	[4]	4,188,000 @17,897	[5]	8,214,000 @17,041	[4]	7,529,000 @17,841	[2]	7,061,600 @16,655	[2]	7,061,600 @16,655	[2]	6,238,100 @14,145	[5]	7,512,000 @17,971	[B1]	3,685,400 @15,683	[B1]	3,685,400 @15,750	[B1]	7,228,300 @14,996	[B1]	6,625,500 @15,700	[B1]	6,610,500 @15,815	[A1]	3,559,800 @15,148	[A1]	3,559,800 @15,213	[A1]	6,981,900 @14,485	[A1]	6,399,600 @15,165	[A1]	6,385,200 @15,276
[4]	4,178,000 @17,779	[4]	4,178,000 @17,855			[4]	7,509,000 @17,794	[2]	6,389,600 @15,070	[2]	6,389,600 @15,070	[2]	6,441,600 @14,607	[5]	7,491,000 @17,921	[B1]	3,676,600 @15,645	[B1]	3,676,600 @15,712			[B1]	6,607,900 @15,659	[B1]	6,592,000 @15,770	[A1]	3,551,300 @15,112	[A1]	3,551,300 @15,176	[A1]	6,382,600 @15,125	[A1]	6,367,300 @15,233		
[4]	4,167,000 @17,732	[4]	4,167,000 @17,808			[4]	7,489,000 @17,746	[2]	6,372,900 @15,030	[2]	6,372,900 @15,030	[2]	6,414,800 @14,546	[5]	7,472,000 @17,876	[B1]	3,666,900 @15,604	[B1]	3,666,900 @15,671			[B1]	6,590,300 @15,617	[B1]	6,575,300 @15,730	[A1]	3,541,900 @15,072	[A1]	3,541,900 @15,136	[A1]	6,365,600 @15,084	[A1]	6,351,200 @15,194		
[4]	4,155,000 @17,681	[4]	4,155,000 @17,756	[5]	8,151,000 @16,911	[4]	7,471,000 @17,704	[2]	6,347,100 @14,970	[2]	6,347,100 @14,970	[2]	6,408,100 @14,531	[5]	7,452,000 @17,828	[B1]	3,656,400 @15,559	[B1]	3,656,400 @15,626	[B1]	7,228,300 @14,996	[B1]	6,574,400 @15,579	[B1]	6,557,700 @15,688	[A1]	3,531,700 @15,029	[A1]	3,531,700 @15,093	[A1]	6,350,300 @15,048	[A1]	6,334,200 @15,154		
[4]	4,155,000 @17,681	[4]	4,155,000 @17,756	[5]	8,151,000 @16,911	[4]	7,471,000 @17,704	[2]	6,347,100 @14,970	[1]	6,342,700 @14,095	[2]	6,408,100 @14,531	[5]	7,452,000 @17,828	[B1]	3,656,400 @15,559	[B1]	3,656,400 @15,626	[B1]	7,172,800 @14,881	[B1]	6,574,400 @15,579	[B1]	6,557,700 @15,688	[A1]	3,531,700 @15,029	[A1]	3,531,700 @15,093	[A1]	6,928,300 @14,374	[A1]	6,350,300 @15,048	[A1]	6,334,200 @15,154
[4]	4,134,000 @17,591	[4]	4,134,000 @17,667	[5]	8,108,000 @16,822	[4]	7,433,000 @17,614	[2]	6,098,100 @14,382	[1]	6,319,200 @14,043	[2]	6,375,600 @14,457	[5]	7,414,000 @17,737	[B1]	3,637,900 @15,480	[B1]	3,637,900 @15,547	[B1]	7,135,000 @14,803	[B1]	6,541,000 @15,500	[B1]	6,524,300 @15,608	[A1]	3,513,900 @14,953	[A1]	3,513,900 @15,017	[A1]	6,891,800 @14,298	[A1]	6,318,000 @14,972	[A1]	6,301,900 @15,076
[4]	4,122,000 @17,540	[4]	4,124,000 @17,624	[5]	8,087,000 @16,778	[4]	7,413,000 @17,566	[2]	6,296,900 @14,851	[1]	6,302,500 @14,006	[2]	6,611,700 @14,993	[5]	7,394,000 @17,689	[B1]	3,627,300 @15,435	[B1]	3,629,100 @15,509	[B1]	7,116,500 @14,765	[B1]	6,523,400 @15,458	[B1]	6,506,700 @15,566	[A1]	3,503,700 @14,909	[A1]	3,505,400 @14,980	[A1]	6,873,900 @14,261	[A1]	6,301,000 @14,931	[A1]	6,284,900 @15,036
[4]	4,112,000 @17,498	[4]	4,113,000 @17,577			[4]	7,393,000 @17,519	[2]	6,540,400 @15,425	[1]	6,536,700 @14,526	[2]	6,343,000 @14,383	[5]	7,375,000 @17,644	[B1]	3,618,500 @15,398	[B1]	3,619,400 @15,468			[B1]	6,505,800 @15,417	[B1]	6,490,000 @15,526	[A1]	3,495,200 @14,873	[A1]	3,496,000 @14,940	[A1]	6,284,000 @14,891	[A1]	6,268,700 @14,855	[A1]	6,252,600 @14,958
[4]	4,101,000 @17,451	[4]	4,102,000 @17,530			[4]	7,375,000 @17,476	[2]	7,131,000 @16,818	[1]	7,126,000 @15,836	[2]	7,188,000 @16,299	[5]	7,356,000 @17,598	[B1]	3,608,800 @15,357	[B1]	3,609,700 @15,426			[B1]	6,490,000 @15,379	[B1]	6,473,200 @15,486	[A1]	3,485,800 @14,833	[A1]	3,486,700 @14,900	[A1]	7,375,000 @17,644	[A1]	6,268,700 @14,855	[A1]	6,252,600 @14,958
[4]	4,091,000 @17,409	[4]	4,092,000 @17,487	[4]	8,025,000 @16,649	[4]	7,355,000 @17,429	[2]	6,258,500 @14,761	[1]	6,253,200 @13,896	[2]	6,298,700 @14,283	[5]	7,338,000 @17,555	[B1]	3,600,000 @15,319	[B1]	3,600,900 @15,388	[4]	8,025,000 @16,649	[4]	7,355,000 @17,429	[4]	7,338,000 @17,555	[A1]	3,477,300 @14,797	[A1]	3,478,200 @14,864	[A1]	7,062,000 @14,651	[A1]	6,472,400 @15,337	[A1]	6,457,400 @15,448
[4]	4,081,000 @17,366	[4]	4,080,000 @17,436	[4]	8,004,000 @16,606	[4]	7,336,000 @17,384	[2]	6,232,700 @14,700	[1]	6,236,500 @13,859	[2]	6,293,700 @14,271	[5]	7,319,000 @17,510	[B1]	3,591,200 @15,282	[B1]	3,590,400 @15,344	[4]	8,004,000 @16,606	[4]	7,336,000 @17,384	[4]	7,319,000 @17,510	[A1]	3,468,800 @14,761	[A1]	3,468,000 @14,821	[A1]	6,803,400 @14,115	[A1]	6,235,600 @14,776	[A1]	6,221,100 @14,883
[5]	4,071,000 @17,323	[5]	4,069,000 @17,389	[4]	7,982,000 @16,560	[4]	7,318,000 @17,341	[2]	7,075,000 @16,686	[1]	7,069,000 @15,709	[2]	7,133,000 @16,175	[5]	7,300,000 @17,464	[B1]	3,582,400 @15,244	[B1]	3,580,700 @15,302	[B1]	7,024,100 @14,573	[B1]	6,439,800 @15,260	[B1]	6,424,000 @15,368	[A1]	3,460,300 @14,725	[A1]	3,458,600 @14,780	[A1]	6,784,700 @14,076	[A1]	6,220,300 @14,740	[A1]	6,205,000 @14,844
19/F REFUGE FLOOR 避火層																																			
[5]	4,060,000 @17,277	[5]	4,059,000 @17,346			[4]	7,298,000 @17,294	[2]	6,456,200 @15,227	[1]	6,451,600 @14,337	[2]	6,250,300 @14,173	[5]	7,280,000 @17,416	[B1]	3,572,800 @15,203	[B1]	3,571,900 @15,265			[B1]	6,422,200 @15,218	[B1]	6,406,400 @15,326	[A1]	3,451,000 @14,685	[A1]	3,450,100 @14,744	[A1]	6,203,300 @14,700	[A1]	6,203,300 @14,700	[A1]	6,188,000 @14,804
[5]	4,052,000 @17,243	[5]	4,051,000 @17,312			[4]	7,284,000 @17,261	[2]	6,196,900 @14,615	[1]	5,980,600 @13,290	[2]	6,238,000 @14,145	[5]	7,266,000 @17,383	[B1]	3,565,700 @15,173	[B1]	3,564,800 @15,234			[B1]	6,409,900 @15,189	[B1]	6,394,000 @15,297	[A1]	3,444,200 @14,656	[A1]	3,443,300 @14,715	[A1]	6,191,400 @14,672	[A1]	6,191,400 @14,672	[A1]	6,176,100 @14,775
[5]	4,044,000 @17,209	[5]	4,044,000 @17,282	[4]	7,931,000 @16,454	[4]	7,269,000 @17,225	[2]	7,028,000 @16,575	[1]	7,022,000 @15,604	[2]	7,086,000 @16,068	[5]	7,252,000 @17,349	[B1]	3,558,700 @15,143	[B1]	3,558,700 @15,208	[B1]	6,979,200 @14,480	[B1]	6,396,700 @15,158	[B1]	6,381,700 @15,267	[A1]	3,437,400 @14,627	[A1]	3,437,400 @14,690	[A1]	6,741,300 @13,986	[A1]	6,178,600 @14,641	[A1]	6,164,200 @14,747
[5]	4,035,000 @17,170	[5]	4,035,000 @17,244	[4]	7,915,000 @16,421	[4]	7,254,000 @17,190	[2]	6,172,300 @14,557	[1]	6,167,000 @13,704	[2]	6,460,800 @14,650	[5]	7,236,000 @17,311	[B1]	3,550,800 @15,110	[B1]	3,550,800 @15,174	[B1]	6,965,200 @14,451	[B1]	6,383,500 @15,127	[B1]	6,366,600 @15,233	[A1]	3,429,700 @14,594	[A1]	3,429,700 @14,657	[A1]	6,727,700 @13,958	[A1]	6,165,900 @14,611	[A1]	6,150,600 @14,714
[5]	4,028,000 @17,140	[5]	4,027,000 @17,209	[4]	7,899,000 @16,388	[4]	7,240,000 @17,156	[2]	6,160,000 @14,528	[1]	6,154,700 @13,677	[2]	6,211,000 @14,084	[5]	7,222,000 @17,278	[B1]	3,544,600 @15,083	[B1]	3,543,700 @15,144	[B1]	6,951,100 @14,421	[B1]	6,371,200 @15,098	[B1]	6,355,300 @15,204	[A1]	3,423,800 @14,569	[A1]	3,422,900 @14,628	[A1]	6,714,100 @13,930	[A1]	6,154,000 @14,583	[A1]	6,138,700 @14,686
[5]	4,019,000 @17,102	[5]	4,019,000 @17,175	[4]	7,882,000 @16,353	[4]	7,226,000 @17,123	[2]	6,986,000 @16,476	[1]	6,981,000 @15,513	[2]	7,042,000 @15,968	[5]	7,208,000 @17,244	[B1]	3,536,700 @15,050	[B1]	3,536,700 @15,114	[B1]	6,936,100 @14,390	[B1]	6,358,800 @15,068	[B1]	6,343,000 @15,175	[A1]	3,416,100 @14,537	[A1]	3,416,100 @14,599	[A1]	6,699,700 @13,900	[A1]	6,142,100 @14,555	[A1]	6,126,800 @14,657
[5]	4,011,000 @17,068	[5]	4,012,000 @17,145	[4]	7,868,000 @16,324	[4]	7,212,000 @17,090	[2]	6,136,200 @14,472	[1]	6,374,800 @14,166	[2]	6,185,500 @14,026	[5]	7,194,000 @17,211	[B1]	3,529,600 @15,020	[B1]	3,530,500 @15,088	[B1]	6,923,800 @14,365	[B1]	6,346,500 @15,039	[B1]	6,330,700 @15,145	[A1]	3,409,300 @14,508	[A1]	3,410,200 @14,574	[A1]	6,687,800 @13,875	[A1]	6,130,200 @14,527	[A1]	6,114,900 @14,629
[5]	4,002,000 @17,030	[5]	4,002,000 @17,103	[4]	7,852,000 @16,290	[4]	7,196,000 @17,052	[2]	5,915,100 @13,951	[1]	6,118,600 @13,597	[2]	6,418,700 @14,555	[5]	7,179,000 @17,175	[B1]	3,521,700 @14,986	[B1]	3,521,700 @15,050	[B1]	6,909,700 @14,335	[B1]	6,332,400 @15,006	[B1]	6,317,500 @15,114	[A1]	3,401,700 @14,475	[A1]	3,401,700 @14,537	[A1]	6,674,200 @13,847	[A1]	6,116,600 @14,494	[A1]	6,102,100 @14,598
[5]	4,002,000 @17,030	[5]	4,002,000 @17,103	[5]	7,852,000 @16,290	[4]	7,196,000 @17,052	[2]	6,959,000 @16,413	[1]	6,953,000 @15,451	[2]	7,015,000 @15,907	[5]	7,179,000 @17,175	[B1]	3,521,700 @14,986	[B1]	3,521,700 @15,050	[B1]	6,909,700 @14,335	[B1]	6,332,400 @15,006	[B1]	6,317,500 @15,114	[A1]	3,401,700 @14,475	[A1]	3,401,700 @14,537	[A1]	6,674,200 @13,847	[A1]	6,116,600 @14,494	[A1]	6,102,100 @14,598
[5]	3,987,000 @16,966	[5]	3,987,000 @17,038	[5]	7,820,000 @16,224	[4]	7,167,000 @16,983	[2]	6,089,200 @14,361	[1]	6,717,200 @14,927	[2]	6,138,500 @13,920	[5]	7,151,000 @17,108	[B1]	3,508,500 @14,930	[B1]	3,508,500 @14,994	[B1]	6,881,600 @14,277	[B1]	6,306,900 @14,945	[B1]	6,292,800 @15,055	[A1]	3,388,900 @14,421	[A1]	3,388,900 @14,482	[A1]	6,647,000 @13,790	[A1]	6,091,900 @14,436	[A1]	6,078,300 @14,541
[5]	3,979,000 @16,932	[5]	3,979,000 @17,004	[5]	7,805,000 @16,193	[4]	7,156,000 @16,957	[2]	6,086,000 @14,354	[1]	6,081,600 @13,515	[2]	6,381,200 @14,470	[5]	7,135,000 @17,069	[B1]	3,501,500 @14,900	[B1]	3,501,500 @14,964	[B1]	6,868,400 @14,250	[B1]	6,297,200 @14,922	[B1]	6,278,800 @15,021	[A1]	3,382,100 @14,392	[A1]	3,382,100 @14,453	[A1]	6,634,200 @13,764	[A1]	6,082,600 @14,414	[A1]	6,064,700 @14,509
5/F																																			
[5]	3,971,000 @16,898	[5]	3,971,000 @16,970	[5]	7,78																														

Elverum 第 2 座

A1		A2		A3		A5													
4房雙套1儲套廁 實用1467' 天台836' 梯屋1111' 售出0 呎呎1		4房主套1儲套廁 實用1071' 天台750' 梯屋56' 售出0 呎呎1		4房主套1儲套廁 實用1020' 天台33' 天台612' 售出0 呎呎1		4房三套1儲套廁 實用1273' 天台503' 天台715' 售出0 呎呎1													
35/F		日標 開始22/08/06 [SA2] 結束22/10/31		日標 開始22/08/06 [SA2] 結束22/10/31		日標 開始22/08/06 [SA2] 結束22/10/31													
A1		A2		A3		A5		B		C		D		E		F			
3房主套(開廚) 實用701' 售出0 呎呎5		3房(開廚) 實用589' 售出0 呎呎5						2房(開廚) 實用422' 售出5 呎呎0		2房(開廚) 實用411' 售出0 呎呎5		2房(開廚) 實用441' 售出0 呎呎5		2房(開廚) 實用475' 售出5 呎呎0		1房(開廚) 實用302' 售出5 呎呎0			
[5]# 11,358,000 @16,203 [B1]# 9,995,000 @14,258 [A1]# 9,654,300 @13,772								[3] 6,087,900 @14,426 臨: 22/07/30		[5] 7,328,000 @17,830 [B1] 6,448,600 @15,690 [A1] 6,228,800 @15,155				[1] 6,602,600 @13,900 臨: 22/07/30		[3] 4,646,400 @15,385 臨: 22/07/30			
[5]# 11,328,000 @16,160 [B1]# 9,968,600 @14,221 [A1]# 9,628,800 @13,736								[3] 6,296,400 @14,920 臨: 22/07/30		[5] 7,309,000 @17,783 [B1] 6,431,900 @15,649 [A1] 6,212,600 @15,116				[1] 6,332,400 @13,331 臨: 22/07/30		[3] 4,634,000 @15,344 臨: 22/07/30			
[5]# 11,299,000 @16,118 [B1]# 9,943,100 @14,184 [A1]# 9,604,100 @13,701								[3] 6,279,600 @14,881 臨: 22/07/30		[5] 7,291,000 @17,740 [B1] 6,416,000 @15,611 [A1] 6,197,300 @15,079				[1] 6,306,600 @13,277 臨: 22/07/30		[3] 4,612,600 @15,274 臨: 22/07/30			
								[3] 6,264,700 @14,845 臨: 22/07/30		[5] 7,272,000 @17,693 [B1] 6,399,300 @15,570 [A1] 6,181,200 @15,039				[1] 6,551,400 @13,792 臨: 22/07/30		[3] 4,611,200 @15,269 臨: 22/07/30			
		[5]* 9,985,000 @16,952 [B1]* 8,786,800 @14,918 [A1]* 8,487,200 @14,410						[3] 6,238,000 @14,782 臨: 22/07/30		[5] 7,253,000 @17,647 [B1] 6,382,600 @15,529 [A1] 6,165,000 @15,000				[1] 6,284,900 @13,231 臨: 22/07/30		[3] 4,595,900 @15,218 臨: 22/07/30			
A1		A2		A3		A5		B		C		D		E		F			
3房主套(開廚) 實用701' 售出0 呎呎19		3房(開廚) 實用590' 售出13 呎呎6						2房(開廚) 實用422' 售出14 呎呎5		2房(開廚) 實用411' 售出0 呎呎19		2房(開廚) 實用441' 售出11 呎呎8		2房(開廚) 實用474' 售出14 呎呎5		1房(開廚) 實用303' 售出19 呎呎0			
		[5]* 9,968,000 @16,895 [B1]* 8,771,800 @14,867 [A1]* 8,472,800 @14,361						[3] 6,035,000 @14,301 臨: 22/07/30		[5] 7,253,000 @17,647 [B1] 6,382,600 @15,529 [A1] 6,165,000 @15,000				[1] 6,270,800 @13,230 臨: 22/07/30		[3] 4,438,900 @14,650 臨: 22/07/30			
[4]# 11,182,000 @15,951 [B1]# 9,840,100 @14,037 [A1]# 9,504,700 @13,559		[4]* 9,934,000 @16,837 [B1]* 8,741,900 @14,817 [A1]* 8,443,900 @14,312						[3] 6,451,700 @15,288 臨: 22/07/30		[5] 7,215,000 @17,555 [B1] 6,349,200 @15,448 [A1] 6,132,700 @14,921				[1] 6,238,300 @13,161 臨: 22/07/30		[3] 4,577,700 @15,108 臨: 22/07/30			
[4]# 11,153,000 @15,910 [B1]# 9,814,600 @14,001 [A1]# 9,480,000 @13,524		[4]* 9,907,000 @16,792 [B1]* 8,718,100 @14,776 [A1]* 8,420,900 @14,273						[3] 6,199,600 @14,691 臨: 22/07/30		[5] 7,196,000 @17,509 [B1] 6,332,400 @15,407 [A1] 6,116,600 @14,882				[1] 6,212,400 @13,106 臨: 22/07/30		[3] 4,544,800 @14,999 臨: 22/07/30			
[4]# 11,125,000 @15,870 [B1]# 9,790,000 @13,966 [A1]# 9,456,200 @13,490		[3]* 8,525,400 @14,450 臨: 22/07/30						[3] 6,173,700 @14,630 臨: 22/07/30		[5] 7,179,000 @17,467 [B1] 6,317,500 @15,371 [A1] 6,102,100 @14,847		[1] 6,208,400 @14,078 臨: 22/07/30		[1] 6,196,600 @13,073 臨: 22/07/30		[3] 4,521,100 @14,921 臨: 22/07/30			
		[3]* 8,504,300 @14,414 臨: 22/07/30						[3] 7,008,000 @16,607 [B1] 6,167,000 @14,614 [A1] 5,956,800 @14,116		[5] 7,159,000 @17,418 [B1] 6,299,900 @15,328 [A1] 6,085,100 @14,806		[1] 7,036,000 @15,955 [B1] 6,191,600 @14,040 [A1] 5,980,600 @13,561		[1] 7,034,000 @14,840 [B1] 6,189,900 @13,059 [A1] 5,978,900 @12,614		[3] 4,499,100 @14,849 臨: 22/07/30			
		[3]* 8,481,400 @14,375 臨: 22/07/30						[3] 6,781,200 @16,069 臨: 22/07/30		[4] 7,140,000 @17,372 [B1] 6,283,200 @15,288 [A1] 6,069,000 @14,766		[1] 6,176,700 @14,006 臨: 22/07/30		[1] 6,173,200 @13,024 臨: 22/07/30		[3] 4,323,300 @14,268 臨: 22/07/30			
		[3]* 8,795,800 @14,908 臨: 22/07/30						[3] 6,380,200 @15,119 臨: 22/07/30		[4] 7,122,000 @17,328 [B1] 6,267,300 @15,249 [A1] 6,053,700 @14,729		[1] 6,405,000 @14,524 臨: 22/07/30		[1] 6,403,100 @13,509 臨: 22/07/30		[3] 4,463,300 @14,730 臨: 22/07/30			
[4]# 11,009,000 @15,705 [B1]# 9,687,900 @13,820 [A1]# 9,357,600 @13,349		[2]* 8,437,400 @14,301 臨: 22/07/30						[3] 6,954,000 @16,479 [B1] 6,119,500 @14,501 [A1] 5,910,900 @14,007		[4] 7,104,000 @17,285 [B1] 6,251,500 @15,210 [A1] 6,038,400 @14,692		[1] 6,982,000 @15,832 [B1] 6,144,100 @13,932 [A1] 5,934,700 @13,457		[1] 6,980,000 @14,726 [B1] 6,142,400 @12,959 [A1] 5,933,000 @12,517		[3] 4,279,900 @14,125 臨: 22/07/30			
19/F		REFUGE FLOOR 避火層		19/F															
[4]# 10,981,000 @15,665 [B1]# 9,663,200 @13,785 [A1]# 9,333,800 @13,315		[2]* 8,751,000 @14,832 臨: 22/07/30						[3] 6,102,800 @14,462 臨: 22/07/30		[4] 7,085,000 @17,238 [B1] 6,234,800 @15,170 [A1] 6,022,200 @14,653		[1] 6,129,200 @13,898 臨: 22/07/30		[1] 6,370,200 @13,439 臨: 22/07/30		[1] 4,408,400 @14,549 臨: 22/07/30			
[4]# 10,959,000 @15,633 [B1]# 9,643,900 @13,757 [A1]# 9,315,100 @13,288		[2]* 8,399,600 @14,237 臨: 22/07/30						[3] 6,081,300 @14,411 臨: 22/07/30		[4] 7,071,000 @17,204 [B1] 6,222,400 @15,140 [A1] 6,010,300 @14,624		[1] 6,105,100 @13,844 臨: 22/07/30		[1] 6,114,200 @12,899 臨: 22/07/30		[1] 4,409,600 @14,553 臨: 22/07/30			
		[2]* 8,382,000 @14,207 臨: 22/07/30						[3] 6,908,000 @16,370 [B1] 6,079,000 @14,405 [A1] 5,871,800 @13,914		[4] 7,056,000 @17,168 [B1] 6,209,200 @15,108 [A1] 5,997,600 @14,593		[1] 6,936,000 @15,728 [B1] 6,103,600 @13,840 [A1] 5,895,600 @13,369		[1] 6,933,000 @14,627 [B1] 6,101,000 @12,871 [A1] 5,893,000 @12,432		[1] 4,565,900 @15,069 臨: 22/07/30			
		[2]* 8,365,200 @14,178 臨: 22/07/30						[3] 5,859,900 @13,886 臨: 22/07/30		[4] 7,042,000 @17,134 [B1] 6,196,900 @15,078 [A1] 5,985,700 @14,564		[1] 6,081,300 @13,790 臨: 22/07/30		[1] 5,882,000 @12,409 臨: 22/07/30		[1] 4,392,900 @14,498 臨: 22/07/30			
		[2]* 8,348,500 @14,150 臨: 22/07/30						[2] 6,296,100 @14,920 臨: 22/07/30		[4] 7,029,000 @17,102 [B1] 6,185,500 @15,050 [A1] 5,974,600 @14,537		[1] 6,079,000 @13,785 臨: 22/07/30		[1] 6,318,900 @13,331 臨: 22/07/30		[1] 4,233,800 @13,973 臨: 22/07/30			
[4]# 10,872,000 @15,509 [B1]# 9,567,300 @13,648 [A1]# 9,241,200 @13,183		[2]* 8,331,800 @14,122 臨: 22/07/30						[2] 6,867,000 @16,273 [B1] 6,042,900 @14,320 [A1] 5,836,900 @13,832		[4] 7,014,000 @17,066 [B1] 6,172,300 @15,018 [A1] 5,961,900 @14,506		[1] 6,895,000 @15,635 [B1] 6,067,600 @13,759 [A1] 5,860,700 @13,290		[1] 6,892,000 @14,540 [B1] 6,064,900 @12,795 [A1] 5,858,200 @12,359		[1] 4,375,300 @14,440 臨: 22/07/30			
[5]# 10,849,000 @15,476 [B1]# 9,547,100 @13,619 [A1]# 9,221,600 @13,155		[2]* 8,645,800 @14,654 臨: 22/07/30						[2] 6,271,400 @14,861 臨: 22/07/30		[4] 7,001,000 @17,034 [B1] 6,160,800 @14,990 [A1] 5,950,800 @14,479		[1] 6,055,200 @13,731 臨: 22/07/30		[1] 6,043,500 @12,750 臨: 22/07/30		[1] 4,539,300 @14,981 臨: 22/07/30			
[4]# 10,828,000 @15,447 [B1]# 9,528,600 @13,593 [A1]# 9,203,800 @13,130		[3]* 8,629,300 @14,626 臨: 22/07/30						[2] 6,019,200 @14,264 臨: 22/07/30		[4] 6,986,000 @16,998 [B1] 6,147,600 @14,958 [A1] 5,938,100 @14,448		[1] 6,042,900 @13,703 臨: 22/07/30		[1] 6,041,200 @12,745 臨: 22/07/30		[1] 4,356,800 @14,379 臨: 22/07/30			
[5]# 10,828,000 @15,447 [B1]# 9,528,600 @13,593 [A1]# 9,203,800 @13,130		[5]* 9,619,000 @16,303 [B1]* 8,464,700 @14,347 [A1]* 8,176,100 @13,858						[2] 6,840,000 @16,209 [B1] 6,019,200 @14,264 [A1] 5,814,000 @13,777		[4] 6,986,000 @16,998 [B1] 6,147,600 @14,958 [A1] 5,938,100 @14,448		[1] 6,867,000 @15,571 [B1] 6,042,900 @13,703 [A1] 5,836,900 @13,236		[1] 6,865,000 @14,483 [B1] 6,041,200 @12,745 [A1] 5,835,200 @12,311		[1] 4,356,800 @14,379 臨: 22/07/30			
[5]# 10,785,000 @15,385 [B1]# 9,490,800 @13,539 [A1]# 9,167,200 @13,077		[5]* 9,581,000 @16,239 [B1]* 8,431,200 @14,290 [A1]* 8,143,800 @13,803						[2] 6,232,900 @14,770 臨: 22/07/30		[4] 6,959,000 @16,932 [B1] 6,123,900 @14,900 [A1] 5,915,100 @14,392		[1] 6,009,200 @13,626 臨: 22/07/30		[1] 6,254,900 @13,196 臨: 22/07/30		[1] 4,512,700 @14,893 臨: 22/07/30			
[5]# 10,764,000 @15,355 [B1]# 9,472,300 @13,513 [A1]# 9,149,400 @13,052		[5]* 9,561,000 @16,205 [B1]* 8,413,600 @14,260 [A1]* 8,126,800 @13,774						[2] 6,221,000 @14,742 臨: 22/07/30		[4] 6,945,000 @16,898 [B1] 6,111,600 @14,870 [A1] 5,903,200 @14,363		[1] 6,006,800 @13,621 臨: 22/07/30		[1] 6,243,900 @13,173 臨: 22/07/30		[1] 4,321,300 @14,262 臨: 22/07/30			
A1		A2		A3		A5		B		C		D		E		F			
3房主套(開廚) 實用701' 售出0 呎呎1		3房(開廚) 實用590' 售出0 呎呎1		3房主套1儲套廁 實用720' 天台445' 售出0 呎呎1				2房(開廚) 實用422' 售出1 呎呎0		2房(開廚) 實用411' 售出0 呎呎1		2房(開廚) 實用441' 售出1 呎呎0		2房(開廚) 實用474' 售出1 呎呎0		1房(開廚) 實用303' 售出1 呎呎0			
[4]# 10,742,000 @15,324 [B1]# 9,452,900 @13,485 [A1]# 9,130,700 @13,025		[4]* 9,542,000 @16,173 [B1]* 8,396,900 @14,232 [A1]* 8,110,700 @13,747		日標 開始22/08/06 [SA2] 結束22/10/31				[2] 5,970,800 @14,149 臨: 22/07/30		[4] 6,931,000 @16,864 [B1] 6,099,200 @14,840 [A1] 5,891,300 @14,334		[1] 5,994,500 @13,593 臨: 22/07/30		[1] 5,991,900 @12,641 臨: 22/07/30		[1] 4,322,500 @14,266 臨: 22/07/30			
A1		A2		A3		A5		B		C		D		E		F			
3房主套(開廚) 實用701' 售出0 呎呎1		3房(開廚) 實用590' 售出0 呎呎1						2房(開廚) 實用422' 售出1 呎呎0		2房(開廚) 實用411' 售出0 呎呎1		2房(開廚) 實用441' 售出1 呎呎0		2房(開廚) 實用474' 售出1 呎呎0		1房(開廚) 實用303' 售出1 呎呎0			
[5]# 10,721,000 @15,294 [B1]# 9,434,400 @13,458 [A1]# 9,112,800 @13,000		[4]* 9,524,000 @16,142 [B1]* 8,381,100 @14,205 [A1]* 8,095,400 @13,721						[2] 5,959,300 @14,122 臨: 22/07/30		[4] 6,918,000 @16,832 [B1] 6,087,800 @14,812 [A1] 5,880,300 @14,307		[1] 5,983,100 @13,567 臨: 22/07/30		[1] 5,970,400 @12,596 臨: 22/07/30		[1] 4,312,800 @14,234 臨: 22/07/30			
A1		A2		A3		A5		B		C		D		E		F			
3房主套(開廚) 實用652' 天台162' 售出0 呎呎1		3房(開廚)<																	

Elverum 第 2 座

35/F		35/F																35/F							
	G	2房(開廚)		H	2房(開廚)		J	1房(開廚)		K	開放式(開廚)		L	1房(開廚)		M	2房(開廚)		N	2房(開廚)		P	2房(開廚)		
		實用 437'	呎 0		實用 454'	呎 5		實用 309'	呎 0		實用 246'	呎 5		實用 296'	呎 5		實用 475'	呎 5		實用 471'	呎 5		實用 440'	呎 5	
33/F	[4] [B1] [A1]	7,715,000 @17,654 6,789,200 @15,536 6,557,700 @15,006		[1]	6,438,000 @14,181 臨: 22/07/30		[4] [B1] [A1]	5,486,000 @17,754 4,827,600 @15,623 4,663,100 @15,091		[3]	3,602,400 @14,644 臨: 22/07/30					[1]	6,537,500 @13,763 臨: 22/07/30		[5] [B1] [A1]	7,885,000 @16,741 6,938,800 @14,732 6,702,200 @14,230		[5] [B1] [A1]	7,736,000 @17,582 6,807,600 @15,472 6,575,600 @14,945		
32/F	[4] [B1] [A1]	7,695,000 @17,609 6,771,600 @15,496 6,540,700 @14,967		[1]	6,201,600 @13,660 臨: 22/07/30		[4] [B1] [A1]	5,471,000 @17,706 4,814,400 @15,581 4,650,300 @15,050		[3]	3,602,700 @14,645 臨: 22/07/30					[1]	6,779,200 @14,272 臨: 22/07/30		[5] [B1] [A1]	7,864,000 @16,696 6,920,300 @14,693 6,684,400 @14,192		[5] [B1] [A1]	7,716,000 @17,536 6,790,000 @15,432 6,558,600 @14,906		
31/F	[4] [B1] [A1]	7,675,000 @17,563 6,754,000 @15,455 6,523,700 @14,928		[1]	6,660,200 @14,670 臨: 22/07/30		[4] [B1] [A1]	5,458,000 @17,663 4,803,000 @15,544 4,639,300 @15,014		[3]	3,593,900 @14,609 臨: 22/07/30					[1]	6,762,700 @14,237 臨: 22/07/30		[5] [B1] [A1]	7,844,000 @16,654 6,902,700 @14,655 6,667,400 @14,156		[5] [B1] [A1]	7,695,000 @17,489 6,771,600 @15,390 6,540,700 @14,865		
30/F	[4] [B1] [A1]	7,655,000 @17,517 6,736,400 @15,415 6,506,700 @14,889		[1]	6,642,900 @14,632 臨: 22/07/30		[4] [B1] [A1]	5,442,000 @17,612 4,788,900 @15,498 4,625,700 @14,970		[3]	3,728,600 @15,157 臨: 22/07/30					[1]	6,477,300 @13,636 臨: 22/07/30		[5] [B1] [A1]	7,824,000 @16,611 6,885,100 @14,618 6,650,400 @14,120		[5] [B1] [A1]	7,676,000 @17,445 6,754,800 @15,352 6,524,600 @14,829		
29/F	[4] [B1] [A1]	7,636,000 @17,474 6,719,600 @15,377 6,490,600 @14,853		[1]	6,372,000 @14,035 臨: 22/07/30		[4] [B1] [A1]	5,429,000 @17,570 4,777,500 @15,461 4,614,600 @14,934		[3]	3,583,300 @14,566 臨: 22/07/30					[1]	6,470,600 @13,622 臨: 22/07/30		[5] [B1] [A1]	7,804,000 @16,569 6,867,500 @14,581 6,633,400 @14,084		[5] [B1] [A1]	7,656,000 @17,400 6,737,200 @15,312 6,507,600 @14,790		
28/F	[4] [B1] [A1]	7,618,000 @17,472 6,703,800 @15,376 6,475,300 @14,852		[1]	6,372,000 @14,035 臨: 22/07/30		[5] [B1] [A1]	5,411,000 @17,568 4,761,600 @15,460 4,599,300 @14,933		[3]	3,715,800 @14,983 臨: 22/07/30		[5] [B1] [A1]	5,411,000 @18,280 4,761,600 @16,086 4,599,300 @15,538		[1]	6,727,900 @14,164 臨: 22/07/30						[4] [B1] [A1]	7,639,000 @17,361 6,722,300 @15,278 6,493,100 @14,757	
27/F	[4] [B1] [A1]	7,579,000 @17,383 6,669,500 @15,297 6,442,100 @14,775		[1]	6,339,500 @13,964 臨: 22/07/30		[5] [B1] [A1]	5,382,000 @17,474 4,736,100 @15,377 4,574,700 @14,853		[3]	3,578,900 @14,431 臨: 22/07/30		[5] [B1] [A1]	5,382,000 @18,182 4,736,100 @16,000 4,574,700 @15,455		[1]	6,437,200 @13,552 臨: 22/07/30		[5] [B1] [A1]	7,762,000 @16,480 6,830,500 @14,502 6,597,700 @14,008		[4] [B1] [A1]	7,599,000 @17,270 6,687,100 @15,198 6,459,100 @14,680		
26/F	[4] [B1] [A1]	7,560,000 @17,339 6,652,800 @15,259 6,426,000 @14,739		[1]	6,322,800 @13,927 臨: 22/07/30		[5] [B1] [A1]	5,369,000 @17,432 4,724,700 @15,340 4,563,600 @14,817		[3]	3,571,000 @14,399 臨: 22/07/30		[5] [B1] [A1]	5,368,000 @18,135 4,723,800 @15,959 4,562,800 @15,415		[1]	6,420,400 @13,517 臨: 22/07/30		[5] [B1] [A1]	7,742,000 @16,437 6,812,900 @14,465 6,580,700 @13,972		[4] [B1] [A1]	7,580,000 @17,227 6,670,400 @15,160 6,443,000 @14,643		
25/F	[4] [B1] [A1]	7,539,000 @17,291 6,634,300 @15,216 6,408,100 @14,697		[1]	6,556,800 @14,442 臨: 22/07/30		[4] [B1] [A1]	5,355,000 @17,386 4,712,400 @15,300 4,551,700 @14,778		[3]	3,561,300 @14,360 臨: 22/07/30					[1]	6,402,800 @13,480 臨: 22/07/30		[3]	6,986,000 @14,832 臨: 22/07/30		[4] [B1] [A1]	7,560,000 @17,182 6,652,800 @15,120 6,426,000 @14,605		
23/F	[4] [B1] [A1]	7,520,000 @17,248 6,617,600 @15,178 6,392,000 @14,661		[1]	7,147,000 @15,742 6,289,300 @13,853 6,074,900 @13,381		[4] [B1] [A1]	5,341,000 @17,341 4,700,000 @15,260 4,539,800 @14,740		[3]	3,551,600 @14,321 臨: 22/07/30					[1]	7,258,000 @15,280 6,387,000 @13,446 6,169,300 @12,988		[3]	6,700,800 @14,227 臨: 22/07/30		[4] [B1] [A1]	7,540,000 @17,136 6,635,200 @15,080 6,409,000 @14,566		
22/F	[4] [B1] [A1]	7,500,000 @17,202 6,600,000 @15,138 6,375,000 @14,622		[1]	6,513,000 @14,346 臨: 22/07/30		[5] [B1] [A1]	5,327,000 @17,295 4,687,700 @15,220 4,527,900 @14,701		[1]	3,660,900 @14,762 臨: 22/07/30		[5] [B1] [A1]	5,327,000 @17,997 4,687,700 @15,837 4,527,900 @15,297		[1]	6,370,300 @13,411 臨: 22/07/30		[3]	6,949,400 @14,755 臨: 22/07/30		[4] [B1] [A1]	7,521,000 @17,093 6,618,400 @15,042 6,392,800 @14,529		
21/F	[4] [B1] [A1]	7,480,000 @17,156 6,582,400 @15,097 6,358,000 @14,583		[1]	6,506,500 @14,331 臨: 22/07/30		[5] [B1] [A1]	5,314,000 @17,253 4,676,300 @15,183 4,516,900 @14,665		[1]	3,511,700 @14,160 臨: 22/07/30		[5] [B1] [A1]	5,313,000 @17,949 4,675,400 @15,795 4,516,000 @15,257		[1]	6,353,600 @13,376 臨: 22/07/30		[3]	6,666,500 @14,154 臨: 22/07/30		[4] [B1] [A1]	7,501,000 @17,048 6,600,800 @15,002 6,375,800 @14,490		
20/F	[4] [B1] [A1]	7,461,000 @17,112 6,565,600 @15,059 6,341,800 @14,545		[1]	7,093,000 @15,623 6,241,800 @13,748 6,029,000 @13,280		[5] [B1] [A1]	5,300,000 @17,208 4,664,000 @15,143 4,505,000 @14,627		[1]	3,502,000 @14,121 臨: 22/07/30		[5] [B1] [A1]	5,299,000 @17,902 4,663,100 @15,754 4,504,100 @15,217		[1]	7,201,000 @15,160 6,336,800 @13,341 6,120,800 @12,886		[3]	6,658,900 @14,138 臨: 22/07/30		[4] [B1] [A1]	7,481,000 @17,002 6,583,200 @14,962 6,358,800 @14,452		
19/F	REFUGE FLOOR 避火層																								
18/F	[5] [B1] [A1]	7,442,000 @17,069 6,548,900 @15,020 6,325,700 @14,508		[1]	6,214,200 @13,688 臨: 22/07/30		[4] [B1] [A1]	5,286,000 @17,162 4,651,600 @15,103 4,493,100 @14,588		[1]	3,502,400 @14,123 臨: 22/07/30					[1]	6,311,900 @13,288 臨: 22/07/30		[1]	7,311,500 @15,523 臨: 22/07/30		[4] [B1] [A1]	7,462,000 @16,959 6,566,500 @14,924 6,342,700 @14,415		
17/F	[5] [B1] [A1]	7,427,000 @17,034 6,535,700 @14,990 6,312,900 @14,479		[1]	6,211,900 @13,683 臨: 22/07/30		[4] [B1] [A1]	5,275,000 @17,127 4,642,000 @15,071 4,483,700 @14,557		[1]	3,496,200 @14,098 臨: 22/07/30					[1]	6,297,800 @13,259 臨: 22/07/30		[1]	6,628,100 @14,072 臨: 22/07/30		[4] [B1] [A1]	7,447,000 @16,925 6,553,300 @14,894 6,329,900 @14,386		
16/F	[5] [B1] [A1]	7,413,000 @17,002 6,523,400 @14,962 6,301,000 @14,452		[1]	7,045,000 @15,518 6,199,600 @13,656 5,988,200 @13,190		[4] [B1] [A1]	5,265,000 @17,094 4,633,200 @15,043 4,475,200 @14,530		[1]	3,847,000 @15,512 臨: 22/07/30					[1]	7,153,000 @15,059 6,294,600 @13,252 6,080,000 @12,800		[1]	6,604,000 @14,021 臨: 22/07/30		[4] [B1] [A1]	7,433,000 @16,893 6,541,000 @14,866 6,318,000 @14,359		
15/F	[5] [B1] [A1]	7,398,000 @16,968 6,510,200 @14,932 6,288,300 @14,423		[1]	6,188,100 @13,630 臨: 22/07/30		[4] [B1] [A1]	5,254,000 @17,058 4,623,500 @15,011 4,465,900 @14,500		[1]	3,481,200 @14,037 臨: 22/07/30					[1]	6,282,300 @13,226 臨: 22/07/30		[1]	6,590,800 @13,993 臨: 22/07/30		[4] [B1] [A1]	7,418,000 @16,859 6,527,800 @14,836 6,305,300 @14,330		
12/F	[5] [B1] [A1]	7,382,000 @16,931 6,496,100 @14,899 6,274,700 @14,392		[1]	6,175,800 @13,603 臨: 22/07/30		[5] [B1] [A1]	5,245,000 @17,029 4,615,600 @14,986 4,458,200 @14,475		[1]	3,465,100 @13,972 臨: 22/07/30		[5] [B1] [A1]	5,242,000 @17,709 4,612,900 @15,584 4,455,700 @15,053		[1]	6,260,000 @13,179 臨: 22/07/30		[1]	6,353,900 @13,490 臨: 22/07/30		[4] [B1] [A1]	7,402,000 @16,823 6,513,700 @14,804 6,291,700 @14,299		
11/F	[5] [B1] [A1]	7,368,000 @16,899 6,483,800 @14,871 6,262,800 @14,364		[1]	7,004,000 @15,427 6,163,500 @13,576 5,953,400 @13,113		[5] [B1] [A1]	5,233,000 @16,990 4,605,000 @14,951 4,448,000 @14,442		[1]	3,606,000 @14,540 臨: 22/07/30		[5] [B1] [A1]	5,233,000 @17,679 4,605,000 @15,557 4,448,000 @15,027		[1]	7,111,000 @14,971 6,257,600 @13,174 6,044,300 @12,725		[1]	7,472,000 @15,864 6,575,300 @13,960 6,351,200 @13,485		[5] [B1] [A1]	7,388,000 @16,791 6,501,400 @14,776 6,279,800 @14,272		
10/F	[5] [B1] [A1]	7,353,000 @16,865 6,470,600 @14,841 6,250,000 @14,335		[1]	6,150,300 @13,547 臨: 22/07/30		[5] [B1] [A1]	5,222,000 @16,955 4,595,300 @14,920 4,438,700 @14,411		[1]	3,598,600 @14,510 臨: 22/07/30		[5] [B1] [A1]	5,222,000 @17,642 4,595,300 @15,525 4,438,700 @14,996		[1]	6,492,800 @13,669 臨: 22/07/30		[1]	6,553,000 @13,913 臨: 22/07/30		[5] [B1] [A1]	7,373,000 @16,757 6,488,200 @14,746 6,267,000 @14,243		
9/F	[5] [B1] [A1]	7,339,000 @16,833 6,458,300 @14,813 6,238,100 @14,308		[1]	6,128,000 @13,498 臨: 22/07/30		[4] [B1] [A1]	5,213,000 @16,925 4,587,400 @14,894 4,431,000 @14,386		[1]	3,337,100 @13,456 臨: 22/07/30					[1]	6,869,500 @14,462 臨: 22/07/30		[1]	6,548,900 @13,904 臨: 22/07/30		[5] [B1] [A1]	7,359,000 @16,725 6,475,900 @14,718 6,255,100 @14,216		
8/F	[5] [B1] [A1]	7,339,000 @16,833 6,458,300 @14,813 6,238,100 @14,308		[1]	6,975,000 @15,363 6,138,000 @13,520 5,928,700 @13,059		[4] [B1] [A1]	5,213,000 @16,925 4,587,400 @14,894 4,431,000 @14,386		[1]	3,454,800 @13,931 臨: 22/07/30					[1]	7,082,000 @14,909 6,232,100 @13,120 6,019,700 @12,673		[1]	7,442,000 @15,800 6,548,900 @13,904 6,325,700 @13,430		[5] [B1] [A1]	7,359,000 @16,725 6,475,900 @14,718 6,255,100 @14,216		
7/F	[5] [B1] [A1]	7,309,000 @16,764 6,431,900 @14,752 6,212,600 @14,249		[1]	6,113,300 @13,465 臨: 22/07/30		[4] [B1] [A1]	5,192,000 @16,857 4,568,900 @14,834 4,413,200 @14,329		[1]	3,439,900 @13,871 臨: 22/07/30					[1]	6,197,500 @13,047 臨: 22/07/30		[1]	6,522,500 @13,848 臨: 22/07/30		[5] [B1] [A1]	7,328,000 @16,655 6,448,600 @14,656 6,228,800 @14,156		
6/F	[5] [B1] [A1]	7,																							

付款計劃簡介 (招標單位除外)

[A1] 現金付款計劃

- 5% 臨時買賣合約時支付
- 95% 臨時買賣合約後 60 天內【或】發展商發出伙通知書 14 天內支付
- 如有【或】以較早者為準
- 付款方式折扣 (照定價 -5.5%)
- 置業售價折扣 (照定價 -3.5%)
- 額外折扣 (照定價 -5%)
- 新地會會員 (照定價 -1%)
- 2 房或以下額外優惠 2 選 1 (ET2-28N 除外)
 - (照定價 -\$10,000)
 - 家具獎勵積分
- 快樂家庭現金回贈 (如適用)
- 買方的親屬已購買同期數其他單位 (成交價 1%)
- 快樂人生現金回贈 (如適用)
- 2021 至 2023 年內已婚或計劃結婚 (現金回贈 \$5,000)
- 快樂居所 / 工作現金回贈 (如適用)
- 臨約日前一年內居主屯門或 90 年後新地落成單位或現職指定於教育/醫護/銀行/航空/政府部門員工 (現金回贈 \$5,000)
- 發展商不提供備用按揭貸款

[B1] 靈活付款計劃

- 5% 臨時買賣合約時支付
- 5% 臨時買賣合約後 180 天內【或】發展商發出伙通知書 14 天內支付
- 90% 發展商發出伙通知書 14 天內支付
- 如有【或】以較早者為準
- 付款方式折扣 (照定價 -2.5%)
- 置業售價折扣 (2 選 1)
 - (照定價)
 - 印花稅回贈 (成交價 3.75%)
- 額外折扣 (照定價 -5%)
- 新地會會員 (照定價 -1%)
- 2 房或以下額外優惠 2 選 1 (ET2-28N 除外)
 - (照定價 -\$10,000)
 - 家具獎勵積分
- 快樂家庭現金回贈 (如適用)
- 買方的親屬已購買同期數其他單位 (成交價 1%)
- 快樂人生現金回贈 (如適用)
- 2021 至 2023 年內已婚或計劃結婚 (現金回贈 \$5,000)
- 快樂居所 / 工作現金回贈 (如適用)
- 臨約日前一年內居主屯門或 90 年後新地落成單位或現職指定於教育/醫護/銀行/航空/政府部門員工 (現金回贈 \$5,000)
- 特別現金回贈 (如適用)
- 不使用 Super 第二按揭及漸進式供款計劃及 3+2 年貸款計劃 (淨樓價 3%)
- 發展商提供以下一項按揭貸款
 - Super 第二按揭貸款
 - 備用第一按揭貸款
 - 漸進式供款計劃·第一按揭貸款 (只限開放式)
 - King's Key 120 貸款
 - 3+2 年貸款計劃

[C1] 升級靈活付款計劃

- 5% 臨時買賣合約時支付
- 5% 臨時買賣合約後 180 天內【或】發展商發出伙通知書 14 天內支付
- 90% 發展商發出伙通知書 14 天內支付
- 如有【或】以較早者為準
- 付款方式折扣 (照定價)
- 額外折扣 (照定價 -2%)
- 新地會會員 (照定價 -1%)
- 2 房或以下額外優惠 2 選 1 (ET2-28N 除外)
 - (照定價 -\$10,000)
 - 家具獎勵積分
- 快樂家庭現金回贈 (如適用)
- 買方的親屬已購買同期數其他單位 (成交價 1%)
- 快樂人生現金回贈 (如適用)
- 2021 至 2023 年內已婚或計劃結婚 (現金回贈 \$5,000)
- 快樂居所 / 工作現金回贈 (如適用)
- 臨約日前一年內居主屯門或 90 年後新地落成單位或現職指定於教育/醫護/銀行/航空/政府部門員工 (現金回贈 \$5,000)
- 印花稅回贈 (成交價 9%)
- 特別現金回贈 (如適用)
- 不使用 Super 第二按揭及漸進式供款計劃及 3+2 年貸款計劃 (淨樓價 3%)
- 發展商提供以下一項按揭貸款
 - Super 第二按揭貸款
 - 備用第一按揭貸款
 - 漸進式供款計劃·第一按揭貸款 (只限開放式)
 - King's Key 120 貸款
 - 3+2 年貸款計劃

其他優惠 (招標單位除外)

- 優先認購住宅停車位優惠**
價單有 # 之單位
優先抽籤本或其他期數住宅停車位
價單有 * 之單位
- 家具獎勵積分 (如適用)**
由賣方安排並由 Indigo Living Limited 提供
開放式單位 3,000 分
一房單位 3,300 分
兩房單位 5,500 分
- 九巴月票半價優惠**
可購兩張一次·優惠期至 2023/12/31 當日
如巴士公司未能提供該優惠·則以同等值現金代替
- 深圳灣口岸車票半價優惠**
該優惠有效期由永東旅行社進駐發展項目商場後
並提供服務之第一個月份內
- Super 第二按揭貸款簡介 (P=匯豐 P)**
貸款額·利率及還款期以最後審批為準
二按上限淨樓價 30%·貸款期最長 25 年
銀行一按+二按合共上限淨樓價 80%
如超過 20%·首 60 個月 H+1.8% / P-2.5%
如不超過 20%·首 60 個月 H+1.3% / P-2.5%
其後 P-2.5%
提前清還貸款現金回贈
第 2 至 3 年內 (成交價 3%)
第 4 年內 (成交價 2.5%)
第 5 年內 (成交價 2%)
- 備用第一按揭貸款簡介 (P=匯豐 P)**
貸款額·利率及還款期以最後審批為準
一按上限淨樓價 80%·貸款期最長 25 年
銀行一按+二按合共上限淨樓價 80%
如超過 70%·首 36 個月 P-2.5%
如不超過 70%·首 36 個月 P-2.75%
其後 P
- 漸進式供款計劃·第一按揭貸款 (P=匯豐 P)**
貸款額·利率及還款期以最後審批為準
一按上限淨樓價 85%·貸款期最長 30 年
貸款額 40% (A) 首 36 個月 P-2.5%·其後 P
貸款額 30% (B) 首 36 個月免息免供·其後 P
貸款額 30% (C) 首 72 個月免息免供·其後 P
提前清還 (B) 貸款現金回贈
第 2 年內 (成交價 0.75%)
提前清還 (C) 貸款現金回贈
第 2 年內 (成交價 1.75%)
第 3 至 4 年內 (成交價 0.75%)
- King's Key 120 貸款 (P=匯豐 P)**
貸款額·利率及還款期以最後審批為準
買家須提供發展商指定物業作為法定第一抵押
貸款額最高為成交價 120%·貸款期 36 個月
貸款息率 2.38%
如樓價 90% 或以下·月供成交價 0.38%
如樓價 90% 以上·月供成交價 0.5%
先用於支付利息·餘款用於償還樓價貸款及
於到期日·全數償還樓價貸款餘款及利息
另可申請延緩貸款
貸款期最長 20 年·息率全期 P
- 3+2 年貸款計劃 (P=匯豐 P)**
貸款額·利率及還款期以最後審批為準
買家須提供發展商指定金融資產價值證明
貸款額最高為成交價 80%·貸款期 5 年
貸款息率 P (準時每期供款免息)
月供成交價 0.38%
先用於支付利息·餘款用於償還樓價貸款及
於到期日·全數償還樓價貸款餘款及利息
提前清還貸款現金回贈
第 13 至 33 個月內 (成交價 2%)
如使用第 4 至 5 年貸款須支付手續費
餘款為樓價 <= 60% (成交價 1%)
餘款為樓價 > 60% 及 <= 65% (成交價 1.5%)
餘款為樓價 > 65% (成交價 2%)

價單成交分析:

價單	首發日期	單位	已售	可售
[1]	22/07/19	165	133	32
[2]	22/07/24	100	83	17
[3]	22/07/26	123	120	3
[4]	22/07/31	168	0	168
[5]	22/08/02	168	0	168

間隔成交分析:

間隔	總單位	總出售	總未售	已售價單	價單已售	尚餘單位
開放式 (開廚)	187	79	108	157	79	78
1 房 (開廚)	76	26	50	61	26	35
2 房 (開廚)	419	182	237	394	182	212
3 房 (開廚)	54	23	31	50	23	27
3 房主套 (開廚)	79	26	53	62	26	36
3 房主套 1 儲套房	1	0	1	0	0	0
4 房主套 1 儲套房	6	0	6	0	0	0
4 房雙套 1 儲套房	1	0	1	0	0	0
4 房三套 1 儲套房	1	0	1	0	0	0

LAYOUT PLAN OF THE DEVELOPMENT 發展項目的布局圖

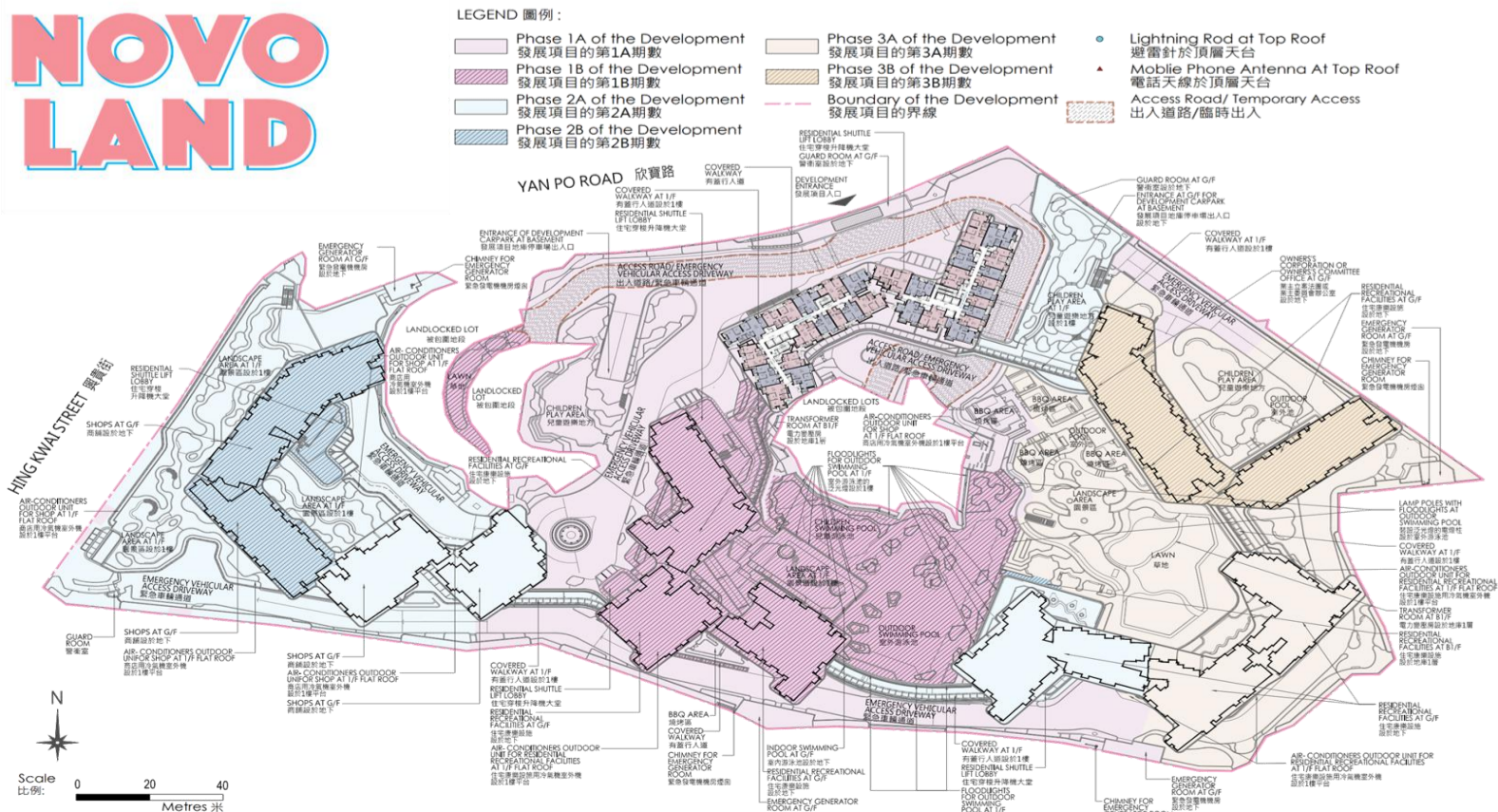

物業簡介資料

中文名稱: Novo Land
 英文名稱: Novo Land
 網址: <https://www.novoland.com.hk/>
 物業地址: 欣寶路 8 號
 區域: 屯門
 單位總數: 824
 關鍵日期: 2023/06/29 (預計)
 校網: 小學 - 70 區
 中學 - 屯門
 可售車位: 私家車 114 個
 電車車 9 個
 發展商: 新鴻基地產
 展銷地址: 鎊安出售首日
 九龍柯士甸道西 1 號
 環球貿易廣場 11 樓
 其後日子
 九龍柯士甸道西 1 號
 環球貿易廣場 21 樓
 開放時間: 鎊安出售首日
 09:00 至 23:00
 其後日子
 14:00 至 20:00 (星期一至五)
 12:00 至 20:00 (星期六及假期)
 律師行: 孖士打律師行
 Mayer Brown
 本票金額: \$100,000